

ELECTRICAL SPECIFICATIONS:

RYD

| | |
|---------------------------------|-------------------|
| Type | SDRP0615FJ04-F1-G |
| Impedance at 1kHz | 32Ω+10%/-20% |
| Rated Input Power | 10mW |
| Maximum Input Power | 50mW |
| Resonance Frequency | 450(+50/-100)Hz |
| Sensitivity at 179mVrms at 1kHz | 110±3dB |
| THD at 179mVrms (300-4000Hz) | <5% (300~4000Hz) |
| | <1% (1kHz) |
| Operating Temperature Range | -20°C ~ +70°C |
| Storage Temperature Range | -40°C ~ +85°C |

DIMENSIONS UNIT:mm Tolerance:±0.2mm

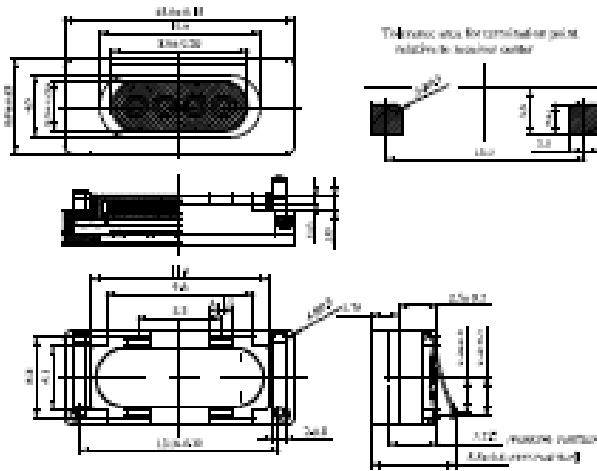

Tolerance general unless otherwise noted: ± 0.13mm